

<b>NN6040</b> Batch 000000	<b>Nissan X-Trail (T31) (From 2007)</b> Type Approval Number E11 55R-01 10422
-------------------------------	--

COMPONENTS		
ITEM	QTY	DESCRIPTION
A	1	Towbar
B	1	Detachable Towbar Neck Kit – ZCA6011 > Detachable Towbar Neck & Housing > Weather Plug > Storage Bag > Operation Manual V2 > Swan Neck Ball Cap (ZM1406)
C	1	Side Arm (L/H)
D	1	Side Arm (R/H)
E	1	Chassis Support (L/H)
F	1	Chassis Support (R/H)
G	1	Captive Bolt Strap (L/H)
H	1	Captive Bolt Strap (R/H)
EP	1	Electrical Mounting Bracket (NN4360-EP)

BOLT PACK		
ITEM	QTY	DESCRIPTION
J	4	M12 x 25 Bolts & Washers
K	3	M12 x 40 Bolts, Washers & 2 Nuts
L	4	M10 x 50 Bolts & Washers
M	2	M10 x 40 Bolts & Washers
N	6	M10 Nuts & Washers
O	4	M8 x 35 Bolts & Washers
P	10	M10 H/D Washers – 30mm O/D x 5mm Thick
Q	4	M8 Washers – 25mm O/D x 3mm Thick
R	4	M12 Washers – 23mm O/D x 1.6mm Thick

FITTING PROCEDURE	
⇒	Remove bumper (1 screw behind plastic cap each side in the tailgate opening, 2 push-in plastic plugs on the lower edge, 2 screws on the underside of the bumper (at the base of each wheelarch), 3 screws around the perimeter of each wheelarch (securing the mudflap). Carefully pull out wheelarch surround from the lower edge sufficiently enough to allow the bumper tips to be pulled out. Remove the exposed bolt at each bumper tip. Remove the 2 screws along the edge of the wheelarch to allow the metal hooked bracket to be lifted away from the bumper.
⇒	Pull down lower edge of bumper and disconnect the fog and reversing lights by turning the bulb holder anti-clockwise. Pull bumper tips outboard to release from clips along bumper-body edge. Pull bumper rearward to release from clips across top edge of rear panel.
⇒	Remove and discard the bumper impact beam and its support brackets (Hand to vehicle operator for retention), to gain access to the chassis openings. Release the rear exhaust silencer from its three rubber hangers and support.
⇒	Insert captive bolt strap (G) into open end of left hand chassis rail and drop through the existing holes in the floor of the chassis. Position chassis support (E) over captive bolts (G) and loosely attach using nuts (N) with heavy duty washers (P). Insert side arm (C) into chassis and align with the two horizontal holes in the outside wall. Thread bolts (L) through washer (P), chassis support (E), chassis wall and into captive nuts on side arm (C), leaving loose.
⇒	Insert captive bolt strap (H) into open end of right hand chassis rail and drop through the existing holes in the floor of the chassis. Position chassis support (F) over captive bolts (H) and loosely attach using nuts (N) with heavy duty washers (P). Insert side arm (D) into chassis and align with the two horizontal holes in the inside wall. Thread bolts (L) through washer (P), chassis support (F), chassis wall and into captive nuts on side arm (D), leaving loose.
⇒	Loosely attach side arms (C) & (D) to the threaded fixings in the vehicle's rear panel using bolts (O) with washers (Q) under the bolt heads.
⇒	Insert towbar (A) between side arms (C) & (D) and attach using 2x bolts (K) on the left hand side, and 1x bolt (K) & 2x bolts (M) on the right hand side.
⇒	Attach detachable towbar neck housing (B) & electrical mounting bracket (EP) to towbar (A) using bolts (J) for use with 12N or 13 Pin Electrical Socket Fitment. <b>Note: Use additional flat washers (R) under the bolt heads. The electrical mounting bracket carries type approval information required by law and must always be fitted as shown.</b>
⇒	<b>For 12S Electrical Socket Fitment (With Extension Plate Option):</b> For 12S Supplementary Socket Additions it will be required to use Extension Plate ZM1364 (Purchased Separately).
⇒	Fully tighten all bolts ensuring all components remain square and level. Reattach exhaust to its hangers.
⇒	Cut section from bumper edge as illustrated and reattach. Reconnect fog & reversing lights.
⇒	<b>NOTE:</b> Please refer to Operation Manual for Use and Maintenance of the Detachable Neck System.
<b><u>TIGHTEN ALL BOLTS</u></b>	
TORQUE SETTINGS ISO Coarse Pitch M8=29Nm, M10=58Nm, M12=102Nm, M16=252Nm ISO Fine Pitch M8=31Nm, M10=61Nm, M12=111Nm	
<b>THE VEHICLE MANUFACTURER'S SPECIFICATION FOR THE TRAILER WEIGHT AND NOSE LOAD LIMITS MUST BE OBSERVED.</b>	

**NN6040**  
Batch 000000

**Nissan X-Trail (T31) (From 2007)**  
Type Approval Number E11 55R-01 10422

**FITTING DIAGRAM**

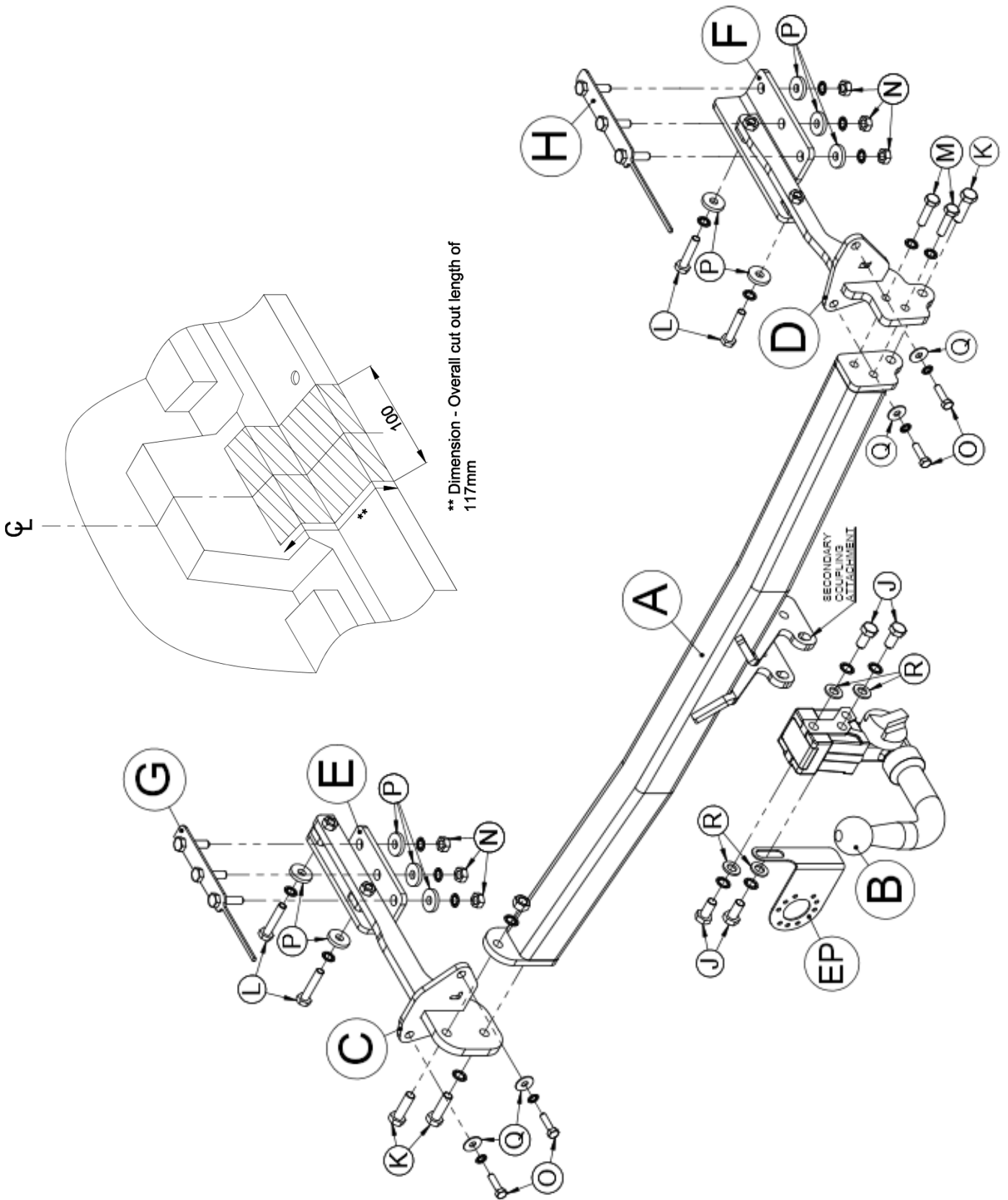

# IMPORTANT PRODUCT INFORMATION & GUARANTEE

## (TO BE RETAINED WITH THE VEHICLE AND PASSED TO SUBSEQUENT OWNERS)

Thank you for purchasing a PCT Automotive product. Please read the following information carefully before fitting or using your PCT Automotive product.

### GUARANTEE

We shall free of charge either repair or at our option replace defective goods where the defects appear

- i. if the goods are a towbar manufactured by us, during the economic lifetime of the vehicle it was first fitted to
- ii. in the case of all other products manufactured by us, within 3 years following the date of your order

PROVIDED THAT (in each case) such defects shall be found to our reasonable satisfaction to have arisen substantially from our faulty design, workmanship or materials and have not arisen by reason of a failure to follow our instructions (whether written or oral), any modification, misuse, neglect or interference with the installation, any damage or abuse to the goods or vehicle by impact or vandalism or by a failure to carry out reasonable inspection, maintenance and/or adjustment.

At all times, the above guarantee is subject to our standard terms and conditions of sale a copy of which is available upon request from our offices.

### TOWING LIMITS

Our towbars have been designed for towing up to the vehicle manufacturer's maximum recommended trailer weight and nose load limits for your model. Towing with gross weights above that recommended at any time will invalidate the guarantee and cancel any liability for damage. Towing a twin axle trailer, towing over rough ground or using a bicycle/motorcycle carrier, etc, exerts extreme loads on to a towbar and extra care should be taken in these situations not to exceed the vehicle manufacturer's maximum recommended limits.

### PRODUCT IDENTIFICATION MARK

Your product carries a product identification mark. This mark carries important product and batch code information and if the product is type approved it also carries the type approval details which are required by law. Under no circumstances should this mark be defaced, removed or damaged.

## INSTALLATION, INSPECTION, MAINTENANCE AND ADJUSTMENT

### GENERAL INSTALLATION

- ⇒ All products should only be fitted by competent persons. Electrical products must only be fitted by an experienced auto-electrician.
- ⇒ Read the product fitting instructions carefully and check all components are included in the fitting kit before commencing installation.
- ⇒ Check vehicle for corrosion and/or accident damage. Towbars should not be fitted to any vehicle suffering from corrosion or accident damage or which is not in a roadworthy condition.
- ⇒ Clean off all road dirt, underseal and sound deadening mastic where parts are to fit to ensure correct seating of all components.
- ⇒ Bumper cut information is given as a guide only. Variations in models may occur therefore the fitter should always check that the bumper cut is necessary and of the correct size and shape before commencing with the cut.
- ⇒ All drilling swarf should be removed from the vehicle and all holes drilled in the vehicle should be treated with an appropriate rust inhibitor.
- ⇒ Do not fully tighten bolts before towbar is completely fitted unless instructed to do so in the fitting instruction, this will allow some variances to be overcome before final tightening of bolts.

### PAINT & CORROSION

Towbars manufactured by PCT Automotive undergo a phosphate chemical pre-treatment prior to a polyester powder coat finish being applied. For long lasting good looks and in order to prevent corrosion the towbar should be regularly inspected for paint damage and wherever necessary re-painted in an appropriate finishing paint or underseal. The vehicle should also be regularly checked for any corrosion that could affect the towbar installation. Towbars should not be used on any vehicle suffering from corrosion that could affect the towbar installation.

### BOLTS

All towbar fixing bolts should be checked initially after the first 300 towing miles, or the initial 500 miles of driving uncoupled, and then every 3,000 towing miles or to coincide with the vehicle manufacturer's recommended service intervals, whichever is the sooner. All towbar fixing bolts should be tightened using an appropriate torque wrench to the settings specified in the towbar fitting instruction.

### ELECTRICAL INSTALLATION, TEST/COMMISSIONING AND MAINTENANCE

Failure to comply with the following instructions may cause damage to the towing vehicle's wiring loom and/or towing electrics installation.

Where displacement tap connectors e.g. Scotchlocks, are the preferred method of connection, always use the correct colour coded tap connector for the size of cable to which it is to be connected. All towing relays and modules manufactured by PCT Automotive have cabling with a copper cross-sectional area in the range 0.5mm<sup>2</sup> to 1mm<sup>2</sup>.

After installation of the 12N/12S sockets, prior to testing, a water displacement agent e.g. WD40 should be applied into the rear connection void through the water drain hole at the bottom of the sockets and also into the front pins under the socket flap. This socket maintenance should be carried out at least twice a year in the spring and autumn.

The towing electrics test procedure must be undertaken with the engine running. If any of the towing relays fail to function correctly, with the engine running and no other vehicle electrical systems turned on, check that the voltage across the vehicle's battery is between 13V and 14V approx, if this voltage is not correct, check the condition of the vehicle's battery/alternator.

Always ensure that the trailer/caravan/lighting board's own electrical systems are installed and functioning correctly before coupling to the vehicle's 12N/12S sockets.

Every six months (spring and autumn recommended) the battery and alternator of the vehicle should be checked to determine correct electrical functioning. All connections of the electrical installation including the earth should be checked for mechanical soundness and electrical quality. Plugs, sockets, relays and fixings should be checked for water ingress, mechanical soundness, electrical quality and general wear and tear.

*Please complete the following information to validate the guarantee and for future reference.*

VEHICLE OWNER NAME & ADDRESS:

VEHICLE MAKE & MODEL:

VEHICLE REGISTRATION NUMBER:

FITTER NAME & ADDRESS:

DATE TOWBAR FITTED:

If you have any comments or suggestions about the PCT Automotive product fitted to your vehicle, please address them to PCT Automotive, New Street, Holbrook Industrial Estate, Sheffield S20 3GH or email [techsupport@pctautomotive.com](mailto:techsupport@pctautomotive.com)  
Your comments will help us in our aim to continually upgrade our products to meet the high standards expected by our customers.